

EXPEDITIONS / THE ARCTIC

TOTAL ECLIPSE AND GREENLAND

13 Days / 12 Nights On Board

Reykjavik to Kangerlussuaq

[BOOK NOW!](#)

[REQUEST A QUOTE](#)

Experience Nature's Most Dazzling Phenomenon in One of the World's Most Awe-Inspiring Destinations

Embark on a breathtaking Arctic adventure aboard the Ocean Albatros to witness a total solar eclipse off Greenland's wild and rugged Blosseville Coast — a rare spectacle in one of the world's most breathtaking destinations. From the vibrant Icelandic capital of Reykjavík, set sail along East Greenland's dramatic coastline—from the remote coasts of totality, where towering glaciers cascade from jagged peaks, to colorful towns with thriving Inuit culture. Cruise through the glacier-lined Prins Christiansund Strait and explore South Greenland's Norse legacy. Discover Nuuk, a captivating capital where tradition meets modernity, before venturing into the awe-inspiring Fjord of Eternity (Evighedsfjord), where colossal glaciers plunge into crystal-clear waters. Prepare to be captivated by Greenland's raw wilderness and timeless culture on this once-in-a-lifetime expedition.

Expedition Dates

Ship	Arrive	Board	Disembark
 Ocean Albatros	Aug 10, 2026	Aug 10, 2026	Aug 22, 2026

TOTAL ECLIPSE AND GREENLAND

13 DAYS / 12 NIGHTS ON BOARD

REYKJAVIK TO KANGERLUSSUAQ

Experience nature's most dazzling phenomenon in one of the world's most awe-inspiring destinations.

Embark on a breathtaking Arctic adventure aboard the Ocean Albatros to witness a total solar eclipse off Greenland's wild and rugged Blosseville Coast—a rare spectacle in one of the world's most breathtaking destinations. From the vibrant Icelandic capital of Reykjavík, set sail along East Greenland's dramatic coastline—from the remote coasts of totality, where towering glaciers cascade from jagged peaks, to colorful towns with thriving Inuit culture. Cruise through the glacier-lined Prins Christiansund strait and explore South Greenland's Norse legacy. Discover Nuuk, a captivating capital where tradition meets modernity, before venturing into the awe-inspiring Fjord of Eternity (Evighedsfjord), where colossal glaciers plunge into crystal-clear waters. Prepare to be captivated by Greenland's raw wilderness and timeless culture on this once-in-a-lifetime expedition.

HIGHLIGHTS

- Witness a total solar eclipse in breathtaking Arctic surroundings
- Experience East Greenlandic culture and traditions in Tasiilaq
- Explore iceberg-studded fjords by Zodiac
- Visit Nuuk, Greenland's vibrant capital
- Discover ancient Norse heritage in South Greenland, home of Erik the Red

EXPEDITION DATE ABOARD OCEAN ALBATROS

Board	Disembark
August 10, 2026	August 22, 2026

Day 1, All aboard in Reykjavik!

Hallgrímskirkja Church towers over Reykjavik, a vibrant city known for Nordic cuisine, unique museums, and lively shopping. After safety briefings, we set sail toward East Greenland.

Day 2, At sea, crossing the Denmark Strait

The Denmark Strait, a narrow passage between Iceland and Greenland, teems with rich marine life. Experts guide guests in safely viewing the eclipse. Nearing Greenland, the team shares insights on ecology, geology, and wildlife, preparing guests for Zodiac operations and polar bear safety.



Day 3, Eclipse Day, East Greenland

On Eclipse Day, Ocean Albatros approaches the once-feared Blosseville Coast. Anchoring at the perfect vantage points beneath the eclipse's center line with clear southwestern views, guests disembark by Zodiac to prepare for the celestial show. At 16:37, the partial eclipse begins, building to totality at 17:37, with darkness settling over the landscape. Witness the stunning "Diamond Ring" effect at 17:40 as totality ends. The eclipse concludes by 18:33 as the moon's shadow moves on. After this unforgettable spectacle, guests return to the ship for a gala dinner.

Day 4, Along the Blosseville Coast

We sail south along Greenland's Blosseville Coast, a rugged landscape shaped by volcanic activity around 50 million years ago. First surveyed by explorer Ejnar Mikkelsen, this area has long been navigated by the Inuit. If conditions allow, we may land in this now-uninhabited region of breathtaking beauty.

Day 5, Tasiilaq, East Greenland

Tasiilaq is East Greenland's largest settlement, sitting on rugged Ammassalik Island. Isolated from European contact until its founding as a trading post in 1894, it preserves the unique culture of the Tunumiit people. Once home to Greenland's last shamans, Tasiilaq is the origin of the tupilak, a feared magical creature - now a celebrated art form. Visitors can meet sled dogs (with owners' permission), experience drum dancing, hike tundra meadows, and visit the Stunk Artist's Workshop.

Day 6, Skjoldungen/Saqqisikuik

Today we explore Skjoldungen, a stunning fjord on Greenland's southeast coast, known to locals as Saqqisikuik. Once visited by Inuit and briefly settled in the 20th century, it is now remote and uninhabited. Surrounded by peaks and glaciers, highlights include Thryms Glacier and the valley of Dronning Maries Dal. Weather permitting, we may land to explore or cruise by the glacier.

Day 7, Prins Christian Sund and Appilaattoq

In the morning, we sail through spectacular Prins

Christian Sund, a 60 km iceberg-filled strait linking East and West Greenland. Surrounded by peaks, glaciers, and valleys, it's one of the world's most spectacular waterways. By afternoon, we reach Aappilattoq, a small, remote village beneath granite cliffs, known for its traditional lifestyle, scenic hikes, and famous local choir.

Day 8, Tasermiut and Uunartoq

Tasermiut Fjord is known for its towering granite cliffs and fertile valleys. Once called Ketil's Fjord by Norse settlers, it's now popular with elite climbers and hikers. We sail to Uunartoq Island to relax in geothermal springs with views of drifting icebergs – an experience unmatched even by Iceland's legendary spas!

Day 9, Qassiarsuk and Itilleq Kujalleq

Next, we cruise through Tunulliarfik Fjord to Qassiarsuk, a lush village known for sheep farming and its rich Norse history. Founded in 1924, the modern village sits on the site of Erik the Red's 10th-century farm, Brattahlíð. Legend has it that his wife Thjodhild refused to join her pagan husband's bed until he built her a church – the first in the Americas. In the afternoon, we hike from nearby Itilleq to Igaliku and the ruins of Garðar, the seat of Norse Greenlandic power.

Day 10, At sea, en route to Nuuk

From South Greenland, we sail north along the rugged coast. Nearly all Greenland settlements lie on the western coast, facing the Davis Strait. Warm Atlantic currents enrich these waters, attracting whales, seals,

human hunters, and many seabirds—so keep an eye out during our day at sea!

Day 11, Nuuk, Capital of Greenland

Home to 20,000 residents, Nuuk, Greenland's capital, offers culture, history, and stunning natural beauty. Inhabited since 2200 B.C. by Paleo-Inuit and later Norse settlers, Nuuk is now Greenland's cultural and political center, featuring the Parliament, National Museum (home of the Qilakitsoq mummies), Katuaq cultural center, local art shops, and cozy cafés. Affectionately known as "Nuuk York" by locals, it stands as a singular blend of the ancient and the contemporary.

Day 12, Kangaamiut and Evighedsfjorden

On the final full day, we arrive in Kangaamiut, a village where traditional hunting, fishing, and weather shape daily life. Guests can hike for panoramic views, and enjoy a warm cultural welcome with local crafts, food, and performance. In the afternoon, we venture into Evighedsfjorden—"The Eternity Fjord"—by Zodiac, cruising past majestic glaciers and dramatic bird cliffs, a thrilling and unforgettable finale to our Arctic voyage.

Day 13, Kangerlussuaq disembarkation

As our journey concludes, we sail up the 160 km Kangerlussuaq Fjord and disembark by Zodiac. Though Kangerlussuaq is more known for its Cold War-era military roots and role as a transport hub than cultural heritage, its surrounding wilderness offers striking natural beauty.



Total Eclipse & Greenland

13 Days / 12 Nights On Board

Arrive: August 10, 2026 | Board: August 10, 2026 | Disembark: August 22, 2026

Please note: A separate reservation needs to be made for each cabin requested.

1 Choose a Cabin

Click to select ...

2 Number of Passengers

Click to select ...

3 Cabin Occupancy

Click to select ...

Voyage rates do not include a mandatory \$650 flight transfer package from Kangerlussuaq to Keflavik/Copenhagen.
This \$650 per person flight package will be added to your invoice on booking.

All prices are per-person and are quoted in USD.

Cabin	Berths	Gender	Price
Superior Balcony Stateroom 412	2		\$20,045
Superior Balcony Stateroom 414	2		\$20,045
Balcony Stateroom 404	2		\$19,045

Ocean Albatros Deck Plan

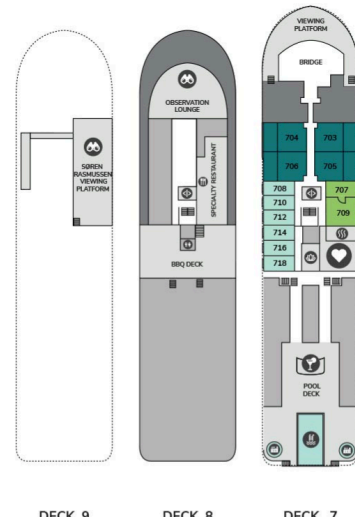

OUR SHIPS

OCEAN ALBATROS

A Next-Generation Ship, Decades in the Making

Beneath the sleek exterior of the Ocean Albatros lies decades of learning and adaptation to the challenging Polar environment. Its patented and ice-conquering X-BOW offers the highest level of stability and comfort, while granting our passenger-explorers unprecedented access to hard-to-reach (and jaw-dropping to discover) corners of this wonderful and often-elusive environment. Its many on board amenities – including two hot tubs with spectacular 360° views – are designed to maximize your every Polar moment, and its spacious heated mudroom with four exterior doors makes zodiac boarding quick, safe, and effortless.

[VIEW DECK PLAN](#)

- ✓ Next-generation expedition ship with Ice Class 1A
- ✓ Patented X-Bow design delivers a smoother ride
- ✓ Two Jacuzzis offer panoramic views
- ✓ Sauna, SPA, gym
- ✓ Multiple observation decks and access points
- ✓ Most cabins have balconies
- ✓ 50% lower carbon footprint compared to previous generation of vessels



Meeting the Polar Challenge, and Then Some

The futuristic X-Bow design of the Ocean Albatros is more than just eye-catching. It's also designed for total comfort and safety in even the roughest seas. And its superior Ice Class 1A and Polar Class 6 mean it can push through deeper ice and deliver access to ever more remote and elusive areas. Onboard, spacious cabins, panoramic views and seamless access to zodiacs (and the adventures to follow) all join forces to ensure a one-of-a-kind experience that will exceed your highest expectations.



From Arctic to Antarctic — Always in Sight

The Ocean Albatros is designed to keep the Polar regions front and center, from wake-up to lights out. Every stateroom provides a generous view, and most include private balconies. A variety of observation decks are accessible from multiple indoor spaces. Two hydraulic platforms can be lowered to offer unprecedented near-water-level views – and rare photograph opportunities. Even the two outdoor Jacuzzis provide 360 views of the mesmerizing landscape that surrounds you.



Voyages to Both Antarctica & the Arctic Include:

- ✓ Beer, wine, and non-alcoholic beverages with dinner
- ✓ Certified Emergency MD and Clinic
- ✓ World Class Cuisine
- ✓ Complimentary coffee/tea station
- ✓ Voyage Photographer
- ✓ Dedicated Passenger Service Manager

Voyages to Just Antarctica Also Include:

- ✓ One Hotel Night
- ✓ Professional Photography Coach
- ✓ Expedition jacket on loan, custom down jacket to keep

All Staterooms Feature:

- ✓ Exterior views
- ✓ Fridge
- ✓ Flat Screen TV
- ✓ Telephone
- ✓ Safe to store your valuables
- ✓ Independent temperature controls
- ✓ Toiletries
- ✓ Hair dryer
- ✓ Bathrobe
- ✓ USB sockets

Ship Facilities:

- ✓ Two Jacuzzis with panoramic views
- ✓ Sauna, SPA, gym
- ✓ Multiple observation decks
- ✓ Main dining restaurant
- ✓ Bistro

Reducing Our Footprint in Every Way Possible

The Ocean Albatros is powered by two diesel and two electro engines, controlled electronically to optimize speed and fuel efficiency. Compared to traditional expedition ships, this technology allows the ship to reduce its carbon footprint by 50%. And by implementing the [Green Initiative Program](#), we ensure the highest standards for both maximum comfort and sustainability practices for our ship, and for all our guests.

[MORE ON BEING RESPONSIBLE](#)

Welcome Aboard Ocean Albatros



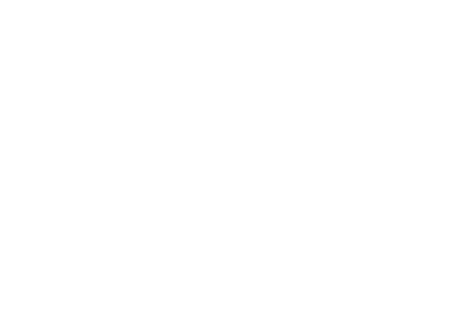

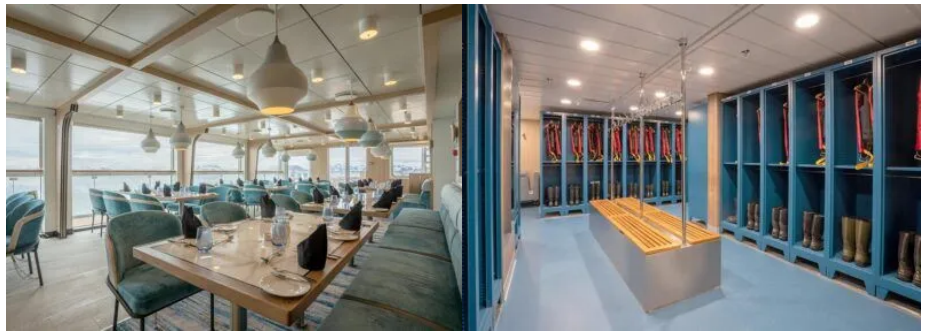

- ✓ 24/7 Grab & Go
- ✓ Private balconies with most cabins
- ✓ Generously-sized communal spaces
- ✓ Spacious bar and lounge area
- ✓ Elevator serving all passenger decks
- ✓ Library with computers
- ✓ Citizen Science Area

Ocean Albatros Deck Plan

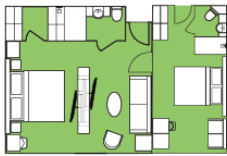
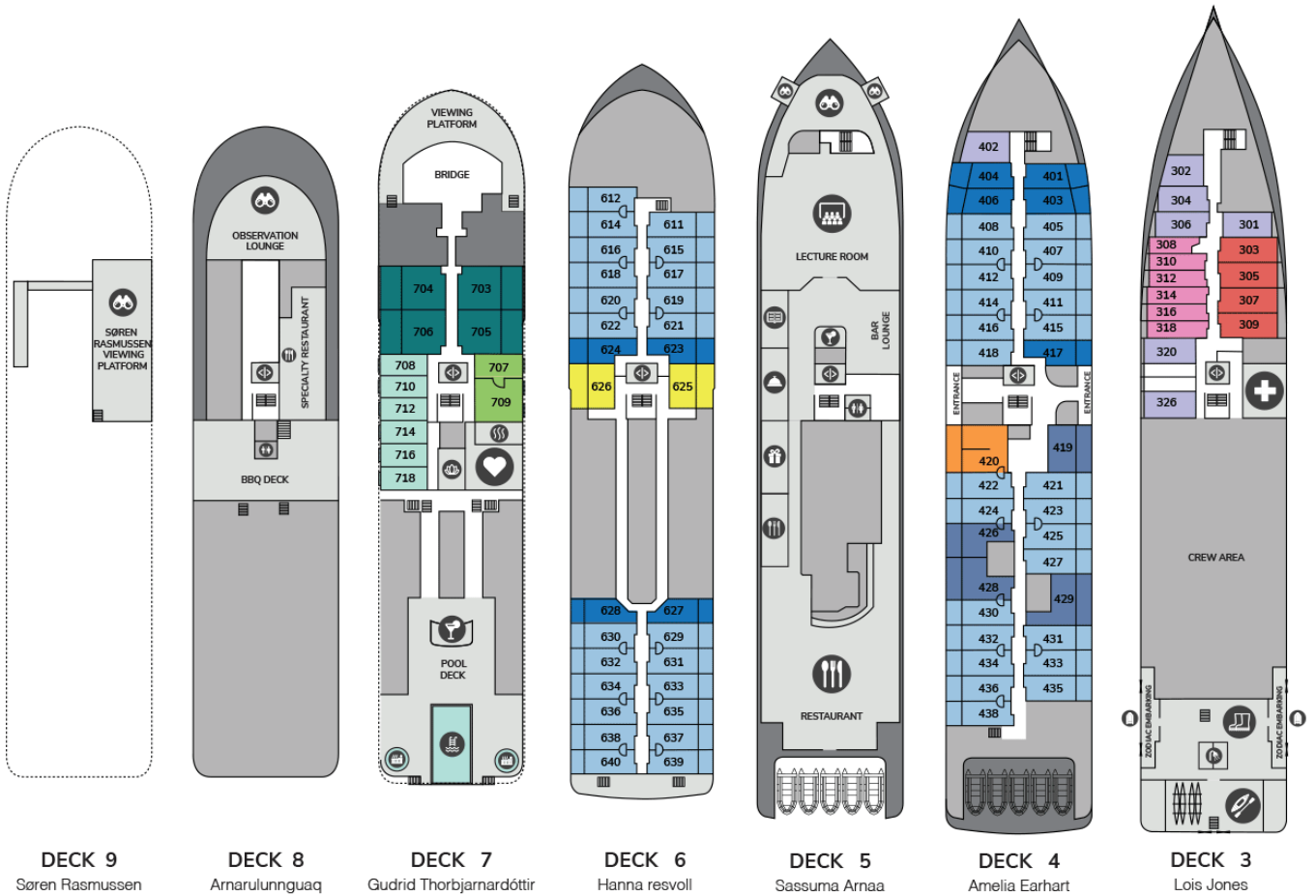

Brynhilde Suite BS
Two Bedroom Suite (1)
52 sqm, French Balcony



Freydis Suite FS
Premium Suite (1)
43 sqm, incl. Balcony

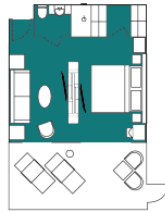

CATEGORY A
Junior Suite (4)
40 sqm, incl. Balcony



CATEGORY B
Balcony Suite (2)
app. 32 sqm, incl. Balcony



CATEGORY CXL
Grand Balcony Stateroom (4)
app. 30 sqm, incl. Balcony

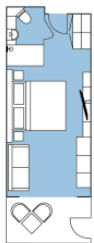

CATEGORY CSP
Superior Balcony Stateroom (48)
app. 24 sqm, incl. Balcony



CATEGORY C
Balcony Stateroom (9)
22 sqm, incl. Balcony



CATEGORY D
Porthole Stateroom (7)
16 sqm, Porthole



CATEGORY E
French Balcony Stateroom (6)
16 sqm, French Balcony



CATEGORY F
Triple Stateroom (4)
20 sqm, Porthole

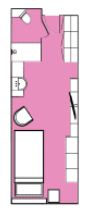

CATEGORY G
Single Stateroom (6)
13 sqm, Porthole



Restaurant



Bar



Observation Area



Lecture Room



Library



Albatros Ocean Boutique



Reception



Medical Clinic



Fitness



Albatros Polar Spa



Infinity Pool



Jacuzzi



Panorama Sauna



Mudroom



Zodiac embarking



Kayak platform



Toilet



Elevator



Shower



Stairs